

Sliding clips with 55mm sliding range

- Material: stainless steel V2A 1.4301
- Sheet thickness: 0,4 mm
- PU: 500 pcs, Height 50 mm 400 pcs

Upper and lower part of the clips are already pre-assembled. By regulating the height above the clip foot a higher stability (lower plastic deformation) of the long sliding clips will be achieved.

Sliding Clips

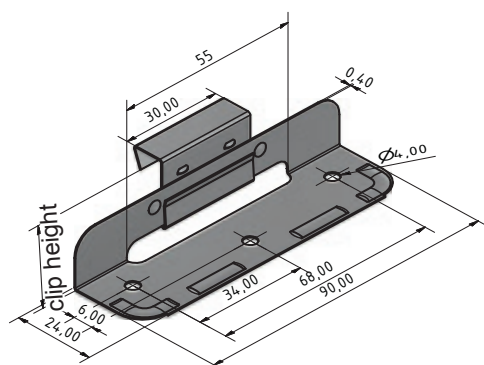

Height	Article-No.
25 mm	P HE16025
28 mm	P HE16028
30 mm	P HE16030
32 mm	P HE16032
38 mm	P HE16038
50 mm	P HE16050

Sliding Clips PLUS

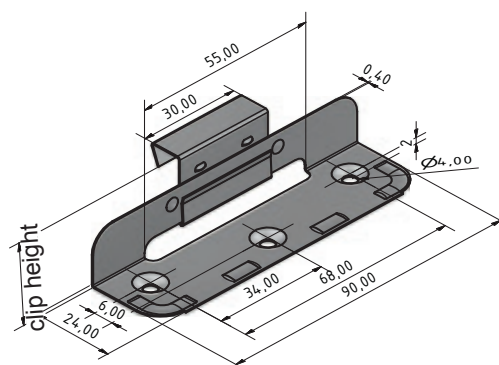

Height	Article-No.
25 mm	P HE16025PL
28 mm	P HE16028PL
30 mm	P HE16030PL
32 mm	P HE16032PL
38 mm	P HE16038PL
50 mm	P HE16050PL

Application

Metal roofs and facades are exposed to external environmental influences such as wind and temperature-induced length expansions. To avoid damage a correct positioning of the fixed and sliding clips is required. The laying arrangement of the sliding clips is dependent on the roof inclination and must be taken from the plumbing/tinsmith rules and regulations of the ZVSHK.

Note: In all cases the technical regulations (of the respective countries), legal regulations (of the respective countries), statics and local conditions must be observed!

Quality

All clips are industrially produced with stamping and bending machines. Internal quality controls ensure a consistently high quality of fastening elements.

Extraction values

The extraction values of the clips depend on the quality of the roof substructure and the fasteners used. For the clips extraction values of 600 N (60 kg) can be assumed. However, the maximum clip distance must not exceed 500 mm.

Fasteners

The following fastening materials must be used for mounting:

- Grooved nails made of stainless steel according to DIN 1052 and according to load capacity class 3/C $\geq 2.5 \times 25$ mm
- Lead covers: Countersunk head screws in stainless steel 4.0 x 25 or 4.0 x 30 mm

Installation

Careful assembly of the individual clips is indispensable. Nails, screws, etc. which are protruding from the surface, should be reworked as this could lead to injuries to the roof skin. When using countersunk head screws as fasteners,

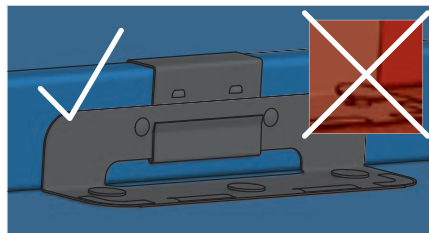

we recommend using the Fixed Clip Plus with countersunk holes.

Roof substructure

The roof skin and its attachment only can hold up the load who the roof substructure can accomplish too. Before mounting the fastening you have to control the substructure. The required nominal thickness of the formwork for roofing is at least 24 mm (22 mm for wood-based panels) at the time of installation.

Use of noise protection mats

When using noise protection mats under the sheet metal panels, the compressed height of the mat must be adapted to the clip height. In the case of Kling sliding clips, the clip height is adjusted over the lower part and this increases the dimensional stability of the clip when using noise protection mats.

Use

Due to the sliding range of 55 mm, the sliding clips can be used depending on the material for the following maximum panel lengths:

- Copper: Total length up to 10 m
- Stainless Steel: Total length up to 14 m
- Aluminium: Total length up to 10 m
- Titanzink: Total length up to 10 m
- Galvanized steel sheet: Total length up to 14 m

Arrangement

The arrangement and the number of fixed clips is dependent on the loads to be absorbed, the inclination of the roof and the expansion possibilities at the ridge and eaves. The fixed clips are arranged on a length of 1–3 m as shown in the figure below. When using snow and solar systems, the number of fixed clips must be adapted to the loads that are to be expected.

Range of fixed clips depending on the inclination of the roof

